

MD002 WiFi Dashcam

User Manual

Manufacture: **MettaX Digital (Shenzhen) Co., Ltd**

Version: V1.1

Date: 2023-12-6

1. Introduction

MD002 HD Hidden Recorder is a small car device for HD video recording, supporting loop recording, emergency locking, and other functions. The product is characterized by small size and strong concealment and can be easily installed in any position in the car to provide security for users.

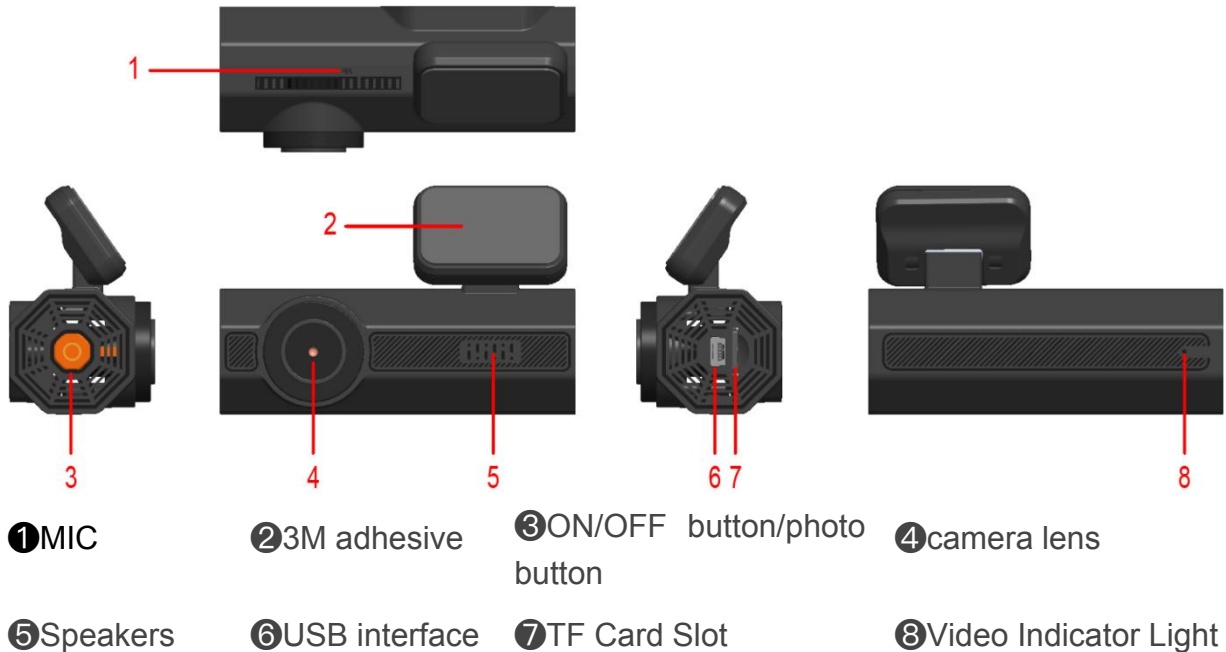

2. Accessory List

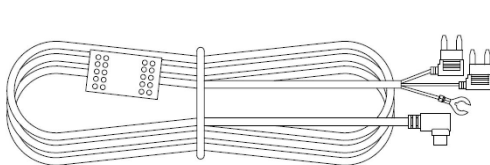

ACC power cable

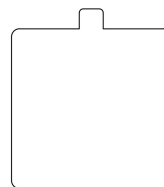

Instruction card



Instruction card

Tip: The illustrations of products, accessories, user interface, etc. in the manual are schematic diagrams for reference only. Due to product updates and upgrades, there may be slight differences between the actual product and the schematic, please refer to the actual product.

3. Basic parameters

Pixel	4 megapixel	Lens	135°
Resolution	2K	Voice prompt language	English
Wi-Fi	Yes	Temp-park motion record	Yes

G-sensor	Yes	Motion detection	Yes
Loop recording	Yes	Date stamp	Yes
Memory card	TF card 128GB Max.	Power interface	Type-C, DC 5V/2A
Voice recording	Supported	Take photos	Supported by APP
Operation temperature	-20 ~ +70°C	Size	92*59.2*36.7mm
Video encoding	H.264	Video format	Ts

4. Button Description

- **Short press:** To lock the video, format the memory card by short-pressing the device for the first time with a new card.
- **Long press:** power on or off.
- **Click five times:** Reset

5. Product Features

- **High Definition**
Adopts high definition camera, capable of realizing 2K HD recording.
- **Hidden installation**
It can be installed in a hidden location in the car without affecting the aesthetics of the car.
- **Loop Recording:**
Support loop recording function, when the memory card storage space is full, it will automatically overwrite the earliest video file.
- **Emergency Lock**
Support emergency lock function, when the vehicle encounters an emergency, it will immediately lock the current video file.
- **Auto Power On Recording**
Support auto power on the recording function, when the vehicle starts, it will start recording automatically.

6. Mobile APP Download



- (1) This product is used with the MettaGO App software. Please search for MettaGO in the app market or scan the QR code below to download and install the app.

- (2) After the device is powered on and enters the working state, find the WIFI that starts with "MettaX-*****" in the WIFI settings of your cell phone, and enter the default password "12345678" to connect.



- (3) Enter MettaGO APP after the connection is completed, the time of the recorder will be synchronized with the current time of the phone. (Be sure to format it the first time you use it on the product. Also to prevent too many emergency video files from taking up memory space on the device, it is recommended to format the memory card 1-3 times per month regularly).

7.Introduction to the basic functions of the APP

- (1) Set up Wi-Fi connection

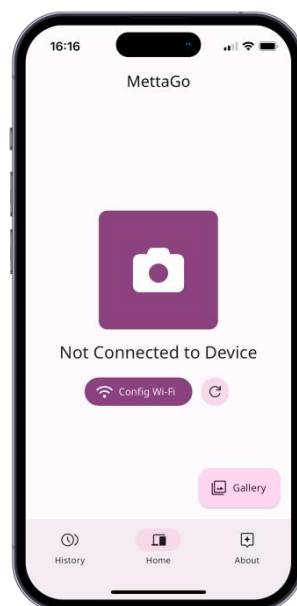

(2) Operator annunciator



(3) Video playback

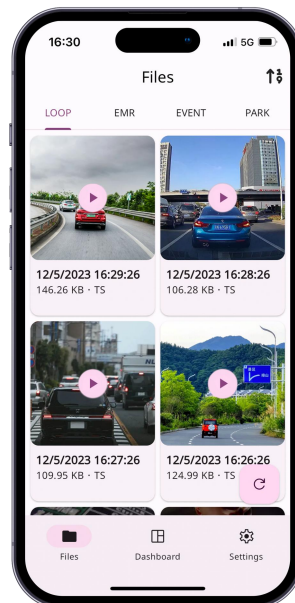

(4) Function setting

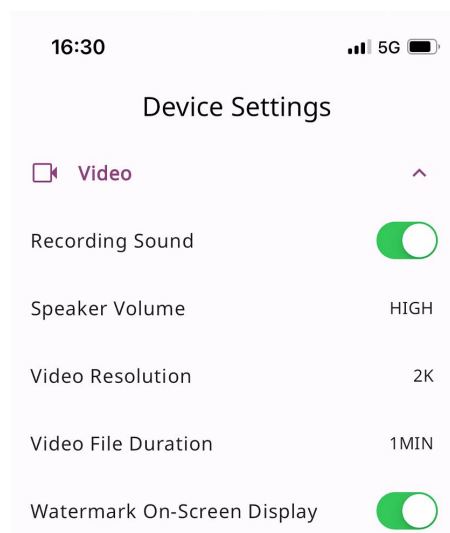

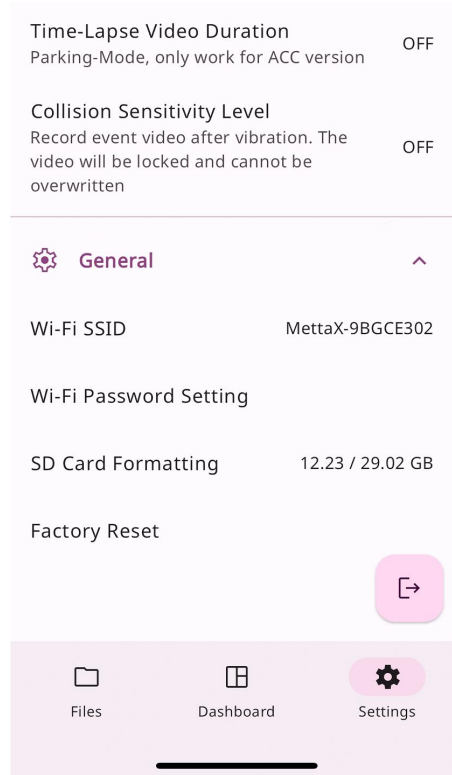

8. Installation method

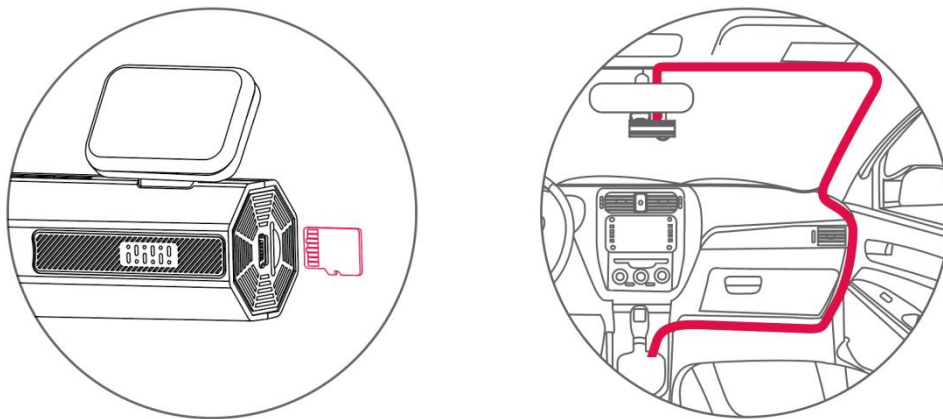

- (1) First turn off the car engine, insert the TF card into the device, and then determine the installation location of the device, which is usually installed on the front and rear windshields of the car.

【Note】 Please use TF memory cards produced by regular manufacturers. You can choose memory cards with a capacity of 8GB-128GB and read/write speeds of no less than U1/Class10 level.

- (2) Clean the mounting location and make sure the surface is clean and dust-free.
- (3) Attach the static sticker to the windshield
- (4) Fix the bracket of the car recorder on the static sticker, and adjust the angle and direction.
- (5) Plug the car adapter into the car battery, the yellow wire connects to the VCC long power, the red wire connects to the ACC firing wire, and the black wire connects to the ground wire.
- (6) Connect the USB port of the recorder to the corresponding position of the car fuse box with a charging extension cable.

【Note】 Wiring can be done by laying the charging extension cord along the edge of the vehicle's windshield.

- (7) After the installation is complete, launch the software and make settings such as time, video quality, recording time, and so on.
- (8) Start the vehicle and check that the equipment is working properly.

【Note】 When the device is installed correctly, the system works to indicate the signal; The device starts to enter the working state and the display shows the video recording in progress.

9. Caveat

Before using this product, please read all precautions and online guides to ensure proper and safe use.

- (1) Please install this product correctly. We are not responsible for any damages caused by installation reasons other than the quality of the product itself.
- (2) Please use the car charger head, power cord, and other accessories that come standard with this product, to avoid the use of malfunctions brought about by inconsistent specifications. We are not responsible for any damage caused by using non-standard car charger heads and power cords.
- (3) Consumers who use power adapters for power supply should purchase power adapters that are CE-certified and meet the standard's requirements.
- (4) Keep this product away from strong magnetic fields, which may cause damage to the product.
- (5) It is prohibited to use this product at high temperatures above 60°C or low temperatures below -10°C.
- (6) Please use this product as permitted by law.

10. Warranty terms

- (1) Merchandise is warranted for one year from the date of departure of the shipment.
- (2) Warranty service is valid only under normal use within the warranty period. If the product is not used according to the requirements of the instruction manual caused by the damage (special attention to the occurrence of water, drop, and other abnormal use is not covered by the warranty).
- (3) The warranty does not cover damages caused by the use of unauthorized and inferior communication cables, equipment failures, and damages caused by force majeure factors such as flood, fire, lightning, earthquake, and other equipment failures and damages that are not caused by the equipment itself.